



DCW/B-480V Camera Users Manual and Installation Instructions

Safety Warning

1. Do not expose the camera to humidity and dust.

Moisture can damage the camera and cause the danger of electric shock. If the camera is mounted outdoors, a camera housing is required. Do not install the camera at where there is greasy smoke or steam, where the humidity is too high, or where there is a lot of dust to prevent damages to the camera.

2. Do not disassemble the camera.

Do not disassemble the camera body as it is dangerous and may cause the damages to the camera. Refer all servicing to qualified service personnel.

3. Handle the camera with care.

Be careful when handling the camera, do not drop it or subject it too strong shock or vibration to prevent any damages to it.

4. Do not install the camera near electric or magnetic fields.

Installed the camera away from TV, radio transmitter, magnet, electric motor, transformer, audio speakers because the magnetic fields generate from above devices will distort the video image.

5. Do not install the camera in the high temperature environment.

Installed the camera away from stoves, or other heat generating devices, or where it could be subject to direct sunlight as the high temperatures could cause deformation, discoloration or other damages of the camera. Install the camera at where the temperature range will stay between 0°C to 50°C (32. to 122.).

6. Cleaning

Use a soft cloth to remove the dirt from the unit. Use lens tissue or a cotton tipped applicator and ethanol to clean the camera lens.



Introduction

The High Resolution DCW/B-480V Dome Camera Series is a compact, full functioned CCD Color Camera. Its stylish appearance can be applied as per installer's ideal locations on the ceiling. This dome camera, designed with advanced digital processing circuitry for high resolution 1/3" color interline transfer CCD sensor, has a DIP switch for AGC on/off, BLC on/off. The dome camera uses a vari-focal auto iris lens for discreet surveillance or close-up viewing and features an iris LEVEL volume control for the best viewing quality.

Main Features

- Designed with advanced digital signal processing circuitry for high image quality.
- The high sensitivity of 1.0 lux / F=1.2 is achieved by high-resolution 1/3" Interline transfer CCD.
- Built-in Vari-Focal type, mechanical auto iris lens, f=3.0-6.0mm, F=1.2~360
- Able to adjust the viewing range with manual zoom lens.
- With manual PAN/TILT mechanism.
- BLC and AGC function on/off switchable.
- Compact size: 108mm O.D. x 80mm H.
- System available for NTSC or PAL

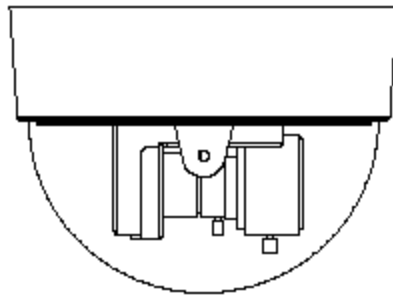



DCW/B-480V Specification

Pickup device:	1/3" Interline transfer CCD
Video format:	NTSC/PAL
Scanning system:	NTSC: 525 TV lines, 60 fields/sec; PAL: 625 TV lines, 50 fields/sec.
Picture elements:	NTSC: 811(H) x 508 (V); PAL: 795 (H) x 596 (V)
Effective picture elements:	NTSC: 768 (H) x 494 (V); PAL: 752 (H) x 582 (V)
Horizontal resolution:	480 TV lines
Sensitivity:	1.0 lux / F=1.2
S/N ratio:	> 48 Db
Varifocal lens:	f=3.0~6.0mm, F=1.2~360 manual zoom and focus adjustment, mechanical auto IRIS
IRIS level:	Adjustable
Back light comp:	On / Off Switch
Auto Gain Control:	On / Off Switch
Auto white balance:	Yes
Gamma correction:	0.45
Monitor output pin:	Yes, 1.0 Vp-p / 75 ohm, test point pin
Video output:	1.0Vp-p/75ohm
Sync. mode:	Internal sync.
Audio:	Available for model High Resolution Dome A
Power source:	12VDC, 300mA
Dimension:	108 mm O.D. x 80 mm H
Operating temperature:	0C to +50C
Power consumption:	5W max.



Major Parts Names and Functions

《High Resolution Dome》

《High Resolution Dome》 (with audio)

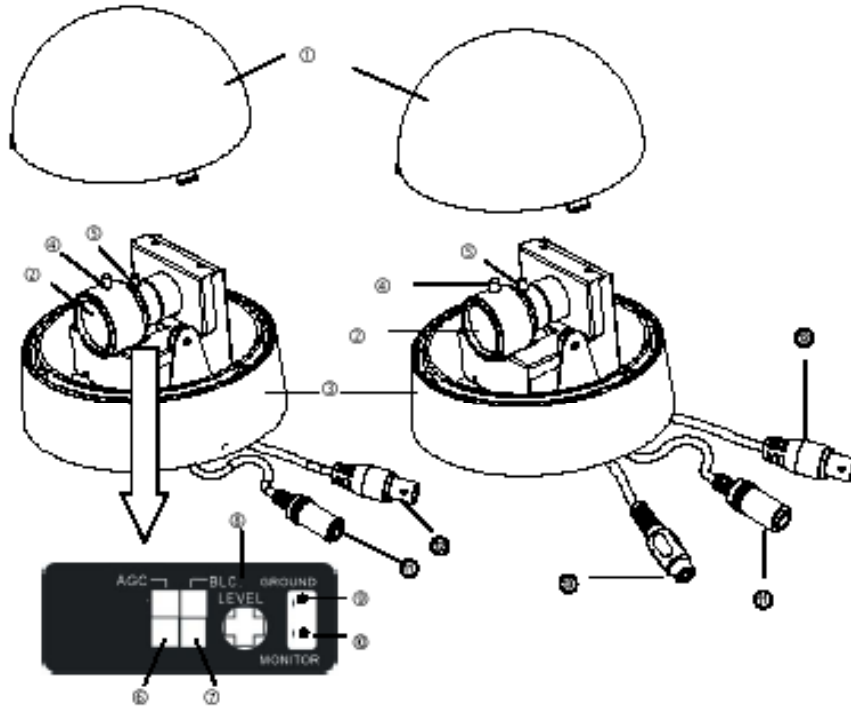

① Camera Cover

This cover will protect the camera from dust and damage.

② Lens

This Vari-Focal Lens allows users to adjust the Zoom and Focus manually.

③ Base

The camera unit is set in the dome base when it is shipped from the factory.

④ Focus Ring

To set the focus, loosen the Focus ring knob first, then turn the ring toward <∞ > or <N> as necessary. When the focus is obtained as desired, tighten the focus ring knob.

⑤ Zoom Ring

Loosen the zoom ring knob, then you can adjust the viewing range. Turn the ring towards <W> for WIDE or <T> for TELE as necessary. When the setting is finished, tighten the zoom ring knob.

⑥ Auto Gain Control on/off switch.

The factory setting is AGC on.

⑦ Back Light Compensation on/off switch

The factory setting is BLC off.

⑧ Level Volume Control

The iris level control for the lens.

⑨ Ground Pin

For monitor use. Please see ⑩.

⑩ Monitor Pin

When setting up the camera, connect a monitor to this video output pin and to the GROUND pin using alligator clip cables, then using the image displayed on the monitor, set the surveillance angle.

⑪ Power input DC-JACK

Use the connector to connect with 12VDC-power adaptor.

⑫ Video Output BNC Connector

Use the connector to connect with the video in connector of a monitor.

⑬ Audio Output RCA Connector

Use the connector to connect with the audio in connector of a monitor.



Installation Instructions

1. Remove the plastic dome cover.
2. Loosen the two screws of the supporting bracket to remove the camera body.
3. Using four screws to fix the camera base on the ceiling.
4. Put the camera body back to the supporting bracket, then tighten the two screws to fix the camera.
5. Connect the BNC connector of the camera to a color monitor, or other video device through a 75 ohm type coaxial cable with BNC female connector at cable extension.
6. Connect the DC+12V regulated power source of the camera (DC Jack) to the DC12V Power-in jack with 2mm, center+, outer-plug.
7. Connect the audio output connector of the camera (model High Resolution Dome A) to the audio in connector of the monitor.

NOTE: Be very careful not to scratch or damage the lens while making any kind of setting.

Lens Adjustments

- **Zoom and focus adjustments**

After the camera was installed, the zoom and focus of the lens must be adjusted.

1. Loosen the zoom ring knob, and then turn the ring towards <W> or <T> as necessary to obtain the desired view range.

W side (Zoom out)

The viewing range will be wider and the subject is smaller.

T side (Zoom in)

The viewing range will be smaller and the subject is larger.

2. Loosen the focus ring knob, then turn the ring towards < ∞ > or <N> as necessary to obtain the clear video image.
3. Repeat steps 2 and 3 until the best image is obtained. Once the lens setting finished, tighten the zoom ring and the focus ring knobs.



Adjustments

- **Auto Gain Control Adjustment**

AGC ON: The sensitivity increases automatically when the light is low.

AGC OFF: A low-noise picture is obtained under a low light condition.

- **Back Light Compensation**

Adjustment

When the background of the subject is very bright and the subject itself is dark, set the BLC (Back Light Compensation) ON. The BLC will measure the light of the image center and the lens iris will automatically set for optimum image quality.

- **Level Volume Control**

The iris level of lens can be adjusted by the level control. Turn the level control to the right direction and video images will become brighter; turn the level control to the left direction and the video images will become darker.

